

**61153**

Hitch application

**Ford F150 Short Box Front Mount Camper Tiedown**

For specific fit, see current fit list  
in our fitlist at [www.dsphitches.com](http://www.dsphitches.com)

#61153

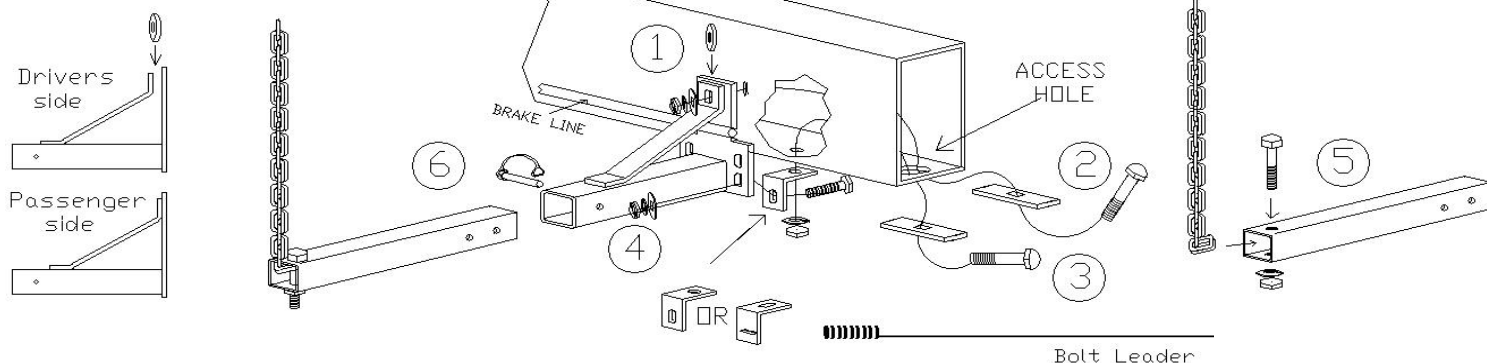

Parts List			Contents of Bolt Pack # 61153/B		Tools Required	
1	Main Body Part # 61315/MBD		4	Carriage Bolt 1/2 x 1-1/2, Grade 5, UNC, Plated	1/2" Socket or Wrench	
1	Main Body Part #61315/MBP		6	Conical Washer 1/2 Style 8 STL Zinc	100 FT/LB Torque Wrench	
2	Tube Chains # 63102		6	Hex Nut 1/2, Grade 5, UNC, Plated	No Drill Application	
2	Sub Bracket # 61153/SBU		2	Hex Bolt 1/2 x 1-1/2, Grade 5, UNC, Plated		
1	Bolt Pack 61153/B		2	Hex Bolt 3/8 x 2-1/4, Grade 5, UNC, Plated		
1	Instructions 61000 Series		2	Lock washer 3/8, Grade 5, Plated		
			2	Hex Nut 3/8, Grade 5, UNC, Plated		
			1	Quick Pin Round 3/8 x 2-1/4		
			4	# 91224 Reinforcement Spacers (rectangular)		
			1	# 91510 3/8 Reinforcement Spacer (round)		
			1	Bolt Leader		
			2	Chain 30", 23 links		
Ship. Weight      29.4 lbs						
Dimensions      19.5" x 8" x 7"						

1) Start with the driver's side installation. The driver's side main body has a gap to slide the brake cable through (not applicable to all truck models). Locate hole (1) on side of frame. Fishwire 1/2" x 1-1/2" carriage bolt and the spacer #91226 (rectangular) through the access hole (2) into this hole. Place round spacer #91510 into the gap of the driver's side main body as shown on left side of the picture above. Loosely attach the camper tiedown as shown in diagram,

2) Locate hole (2) in the bottom of the frame and fish wire 1/2" x 1 1/2" carriage bolt and spacer # 91224 into this hole and attach sub bracket # 61153/SBU. Install the 1/2" x 1-1/2" hex bolt and washer and nut. (As shown in diagram) The sub bracket may be flipped depending on the truck model.

3) Tighten all mounting fasteners to the correct torque specification listed below.

4) Repeat steps 1 and 2 for passenger side of vehicle.

5) For the tube chains: insert the first link into the tube as shown in picture (5) and insert 3/8 hex bolt through tube and chain and secure in place with 3/8 lock washer and 3/8 nut. Tighten all fasteners.

6) Fasten tube chain to main body using the supplied quick pin. Remove when not in use.

Bolt Size	Grade 5 Torque	Metric	Grade 8.8 Torque
3/8	30 Ft. Lb	8 mm	18 Ft. Lb.
7/16	54 Ft. Lb	10 mm	36 Ft. Lb.
1/2	72 Ft. Lb.	12 mm	75 Ft. Lb.
5/8	150 Ft. Lb	14 mm	103 Ft. Lb.
3/4	245 Ft. Lb		

Maximum torque for weld or weld nuts is 38 FT/Lb

**Warning: Check Fasteners annually or before usage, if the Tiedown is damaged replacement may be necessary.**

DO NOT drill or alter this product. This product is only intended for the application listed above, see vehicle owner's manual for maximum camper capacity (GVWR). This product is intended for usage with the correct towing accessories and not to be used with tow ropes, cables, chains or any type of stretch or elastic rope.

DSP Hitches are manufactured by 2114391 Alberta Ltd., Edmonton, Alberta, Canada

For more information on DSP and DSP products call 1-800-265-3377 or visit us at [www.dsphitches.com](http://www.dsphitches.com)