

62712

Hitch application

Universal Rear Camper Tiedown

For Ballmount Application

*NOTE: RECEIVER AND BALLMOUNT NOT INCLUDED

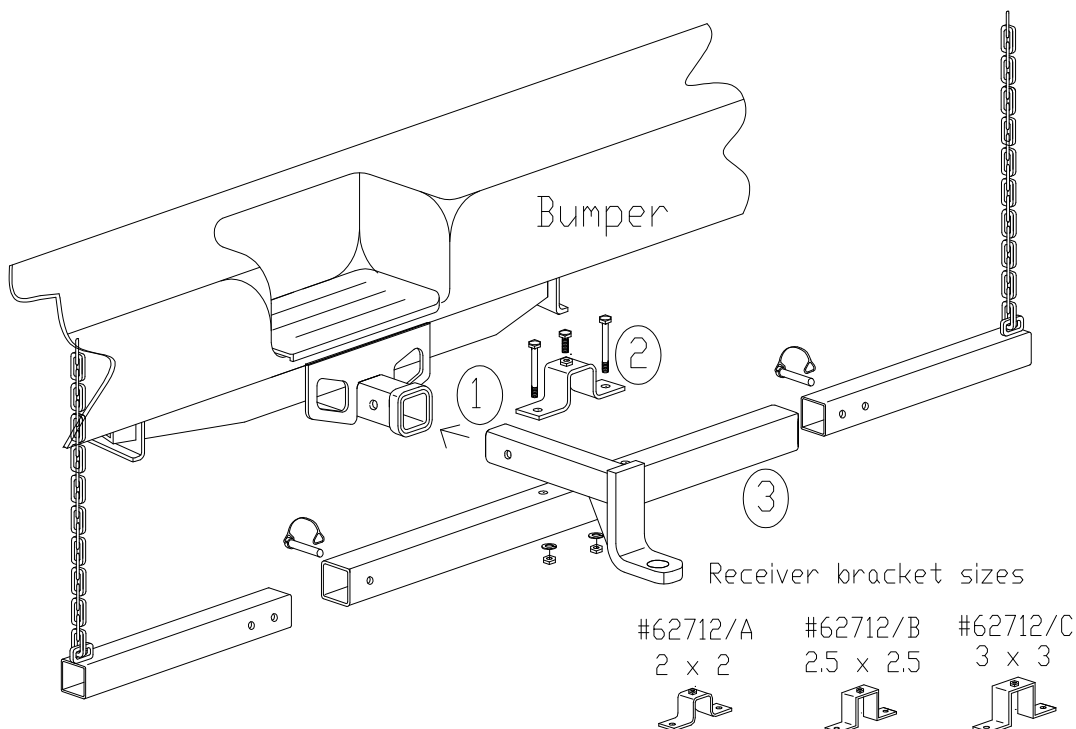

Parts List in addition to 62712/CM - Crossmember

62712/A	62712/B	62712/C	Tools Required
1 x 62712 A Bracket 2" x 2"	1 x 62712 B Bracket 2-1/2" x 2-1/2"	1 x 62712 C Bracket 3" x 3"	1/2" Socket or Wrench 100 FT/LB Torque Wrench
2 x Tube Chains 17"	2 x Tube Chains 17"	2 x Tube Chains 17"	
2 x Quick Pins	2 x Quick Pins	2 x Quick Pins	
1 x Hex Bolt 1/2-13 x 1	1 x Hex Bolt 1/2-13 x 1	1 x Hex Bolt 1/2-13 x 1	No Drill Application
2 x Hex Bolt 1/2 x 3 Full Thread, Gr5	2 x Hex Bolt 1/2 x 3 Full Thread, Gr5	2 x Hex Bolt 1/2 x 3 Full Thread, Gr5	
2 x Lock Nut 1/2, Grade 5	2 x Lock Nut 1/2, Grade 5	2 x Lock Nut 1/2, Grade 5	
Shipping Crossmember 20 lbs	Crossmember 20 lbs	Crossmember 20 lbs	No Drill Application
Weight 62712/A 11.2 lbs	62712/B 11.4 lbs	62712/C 11.5 lbs	

1) Position camper tiedown on the shaft of the ballmount of your choice. Place the supplied 62712 bracket over the ballmount. Secure in place with 1/2" x 3" hex bolts and lock nut.

2) Once in position, install the 1/2" x 1" Hex Bolt on top of the 62712 bracket and tighten to secure in place on the ballmount.

3) Attach tube chains with quick pins. Tighten all mounting fasteners to the correct torque specification listed below.

Bolt Size	Grade 5 Torque	Metric	Grade 8.8 Torque
3/8	30 Ft. Lb.	8 mm	18 Ft. Lb.
7/16	54 Ft. Lb.	10 mm	36 Ft. Lb.
1/2	72 Ft. Lb.	12 mm	75 Ft. Lb.
5/8	150 Ft. Lb.	14 mm	103 Ft. Lb.
3/4	245 Ft. Lb.	Maximum torque for weld or weld nuts is 38 FT/Lb	

Warning: Check Fastens annually or before usage, if the Tiedown is damaged replacement may be necessary.
DO NOT drill or alter this product. This product is only intended for the application listed above.
See vehicle owner's manual for maximum Camper capacity (GVWR). This product is intended for usage with the correct towing accessories and not to be used with tow ropes, cables, chains or any type of stretch or elastic rope.

DSP Hitches are manufactured by 2114391 Alberta Ltd., Edmonton, Alberta, Canada
For more information on DSP and DSP products call 1-800-265-3377 or visit us at www.dsphitches.com