

**62704**

**Hitch Application**

Receiver Mount Square Bend 2-1/2" x 2-1/2"  
Rear Mount  
Camper Tiedowns

**\*\*NOTE: Hitch Receiver is not included**

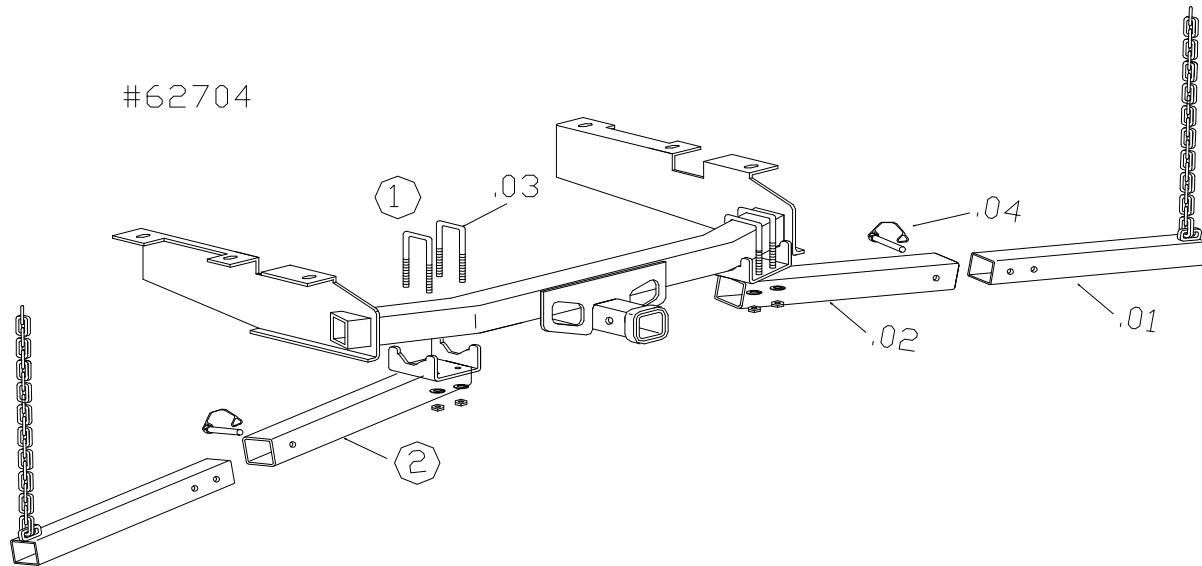

Parts List	Contents of Bolt Pack # 62704/B	Tools Required
1 Mainbody Part # 62704/MBD 1 Mainbody Part # 62704/MBP 2 Tube Chains 17" # 63102 2 Bolt Pack Part # 62704/B 1 Bolt Pack Part # 62704/B 1 Instructions T6200 Series	8 Hex Nut 3/8", Grade 5, UNC, Plated 8 Lock Washer 3/8, Grade 5, Plated 2 Quick Pin Round 3/8 x 2-1/4 4 U BOLT SQ 3/8 x 5-1/2 x 2-1/2 ZINC PL.	9/16" Socket or Wrench 100 FT/LB Torque Wrench
Shipping 32 lbs Weight 15 kg		<b>No Drill Application</b>

- 1) Locate rear receiver. Place U - Bolts over receiver and raise Tiedown up to U - Bolts installed around receiver.
- 2) Install the washers and nuts provided.
- 3) Repeat steps 1 and 2 for passenger side.
- 4) Tighten and torque all mounting fasteners to the correct specification listed below.

Bolt Size	Grade 5 Torque	Metric	Grade 8.8 Torque
3/8	30 Ft. Lb	8 mm	18 Ft. Lb.
7/16	54 Ft. Lb	10 mm	36 Ft. Lb.
1/2	72 Ft. Lb.	12 mm	75 Ft. Lb.
5/8	150 Ft. Lb	14 mm	103 Ft. Lb.
3/4	245 Ft. Lb	Maximum torque for weld or weld nuts is 38 FT/Lb	

**Warning: Check Fasteners annually or before usage, if the Tiedown is damaged replacement may be necessary.**

DO NOT drill or alter this product. This product is only intended for the application listed above.

See vehicle owner's manual for maximum camper capacity (GVWR). This product is intended for usage with the correct towing accessories and not to be used with tow ropes, cables, chains or any type of stretch or elastic rope.

DSP Hitches are manufactured by 2114391 Alberta Ltd., Edmonton, Alberta, Canada

For more information on DSP and DSP products call 1-800-265-3377 or visit us at www.dsphitches.com