

Dodge Front Mount Camper Tiedown

For specific fit, see current fit list
in our catalogue at www.dsphitches.com

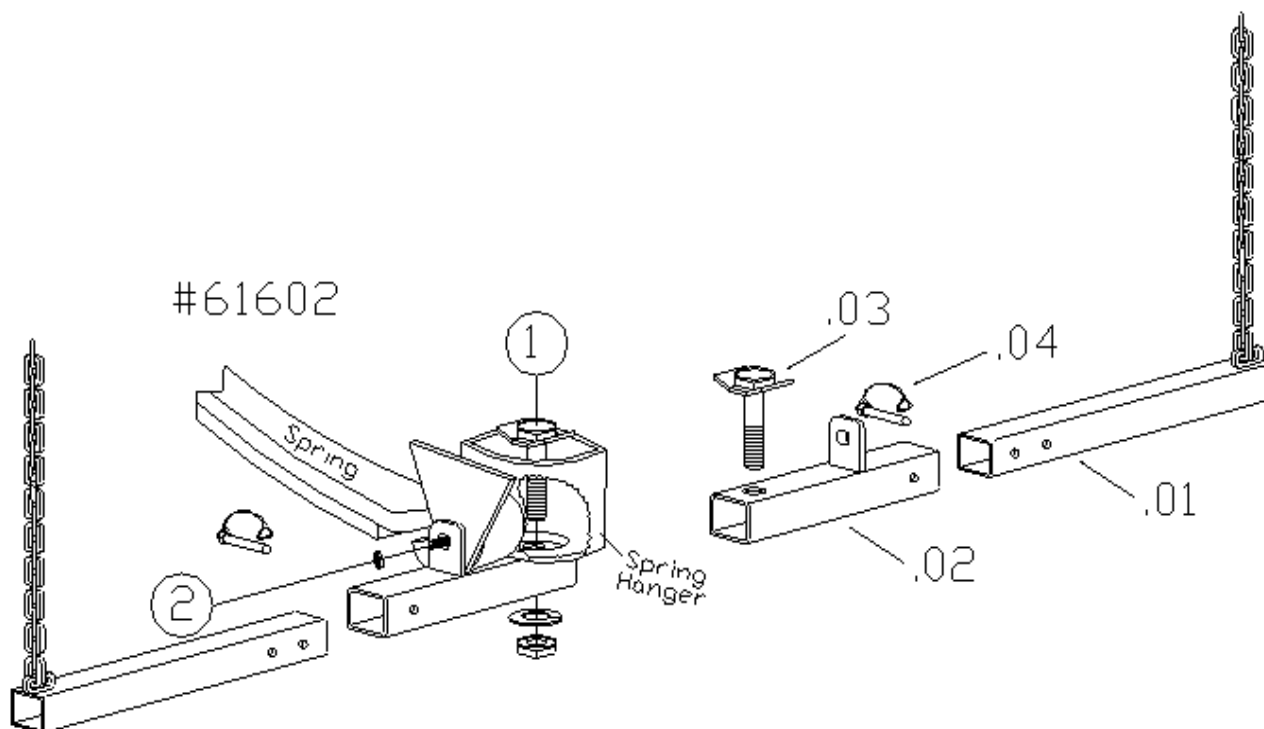

| Parts List | Contents of Bolt Pack # 61602/B | Tools Required |
|---|---|---|
| 2 61602 MAIN BODY DS/PS 2 CT TUBE CHAIN 17" 1 Bolt Pack # 61602/B | 2 Hex Nut 3/4", Grade 5, UNC, Plated 2 Lock Washer 3/4, Grade 5, Plated 2 Quick Pin Round 3/8 x 2-1/4 2 T BOLT 3/4 x 3-1/4 COATED 1 Instructions T6000 Series | 1 1/8" Socket or Wrench 15/16" Socket or Wrench 100 FT/LB Torque Wrench |
| Shipping 23 lbs Weight 11 kg | | No Drill Application |

- 1) Locate front spring hanger bolt (2 - shown in diagram). Remove the nut from the stud bolt and place tiedown over bolt and reinstall the nut.
- 2) Locate the hole in the bottom of the spring hanger and place the specialty t-bolt in that location through the tiedown and install the lock washer and nut provided.
- 3) Repeat steps 1 and 2 for opposite side.
- 4) Tighten all mounting fasteners to their correct torque specifications listed below.

| Bolt Size | Grade 5 Torque | Metric | Grade 8.8 Torque |
|-----------|----------------|--|------------------|
| 3/8 | 30 Ft. Lb | 8 mm | 18 Ft. Lb. |
| 7/16 | 54 Ft. Lb | 10 mm | 36 Ft. Lb. |
| 1/2 | 72 Ft. Lb. | 12 mm | 75 Ft. Lb. |
| 5/8 | 150 Ft. Lb | 14 mm | 103 Ft. Lb. |
| 3/4 | 245 Ft. Lb | Maximum torque for weld or weld nuts is 38 FT/Lb | |

Warning: Check Fastens annually or before usage, if the Tiedown is damaged replacement may be necessary.

DO NOT drill or alter this product. This product is only intended for the application listed above.

See vehicle owner's manual for maximum Camper capacity (GVWR). This product is intended for usage with the correct towing accessories and not to be used with tow ropes, cables, chains or any type of stretch or elastic rope.

DSP Hitches are manufactured by 2114391 Alberta Ltd., Edmonton, Alberta, Canada

For more information on DSP and DSP products call 1-800-265-3377 or visit us at www.dsphitches.com