

Dodge Front Mount Camper Tiedown

For specific fit, see current fit list
in our catalogue at www.dsphitches.com

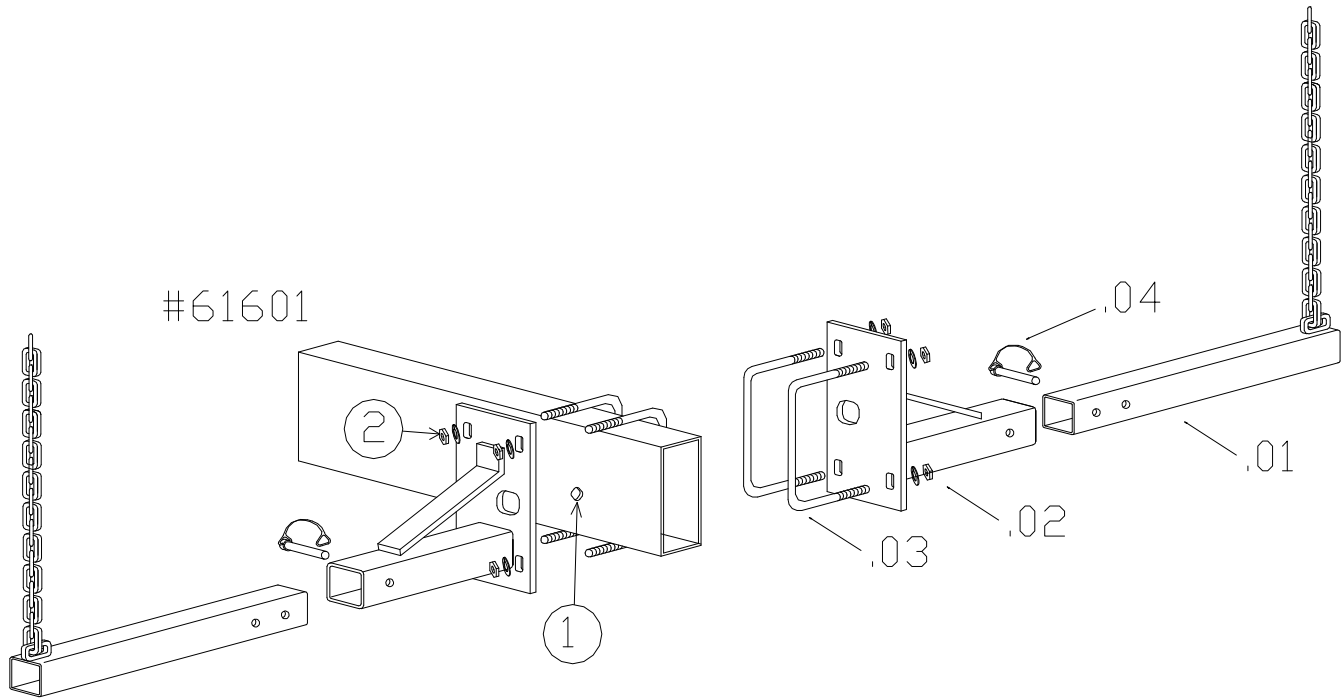

Parts List	Contents of Bolt Pack # 61601B	Tools Required
2 Mainbody 61601/MBU 2 Tube Chains 4 U-Bolts 1/2" 1 Bolt Pack 61601/B	8 Hex Nut 1/2, Grade 5, UNC, Plated 8 Conical Washer 1/2 Style 8 STL Zinc 2 Quick Pin Round 3/8 x 2-1/4 1 DSP Warranty Card 1 Instructions T6000 Series	3/4" Socket or Wrench 100 FT/LB Torque Wrench
Shipping 34 lbs Weight 16 kg		Drill Application

- 1) Position camper tiedown between cab mount and box mount.
- 2) Fasten to the frame using the 1/2" U-Bolts provided. (Refer to diagram above)
- 3) Tighten all mounting fasteners to the correct torque specification listed below.

Bolt Size	Grade 5 Torque	Metric	Grade 8.8 Torque
3/8	30 Ft. Lb	8 mm	18 Ft. Lb.
7/16	54 Ft. Lb	10 mm	36 Ft. Lb.
1/2	72 Ft. Lb.	12 mm	75 Ft. Lb.
5/8	150 Ft. Lb	14 mm	103 Ft. Lb.
3/4	245 Ft. Lb	Maximum torque for weld or weld nuts is 38 FT/Lb	

Warning: Check Fasteners annually or before usage, if the Tiedown is damaged replacement may be necessary.
DO NOT drill or alter this product. This product is only intended for the application listed above, see vehicle owner's manual for maximum camper capacity (GVWR). This product is intended for usage with the correct towing accessories and not to be used with tow ropes, cables, chains or any type of stretch or elastic rope.

