

**61317**

Hitch Application

**CHEVY/GMC Front Mount Camper Tiedown**

For specific fit, see current fit list  
in our catalogue at www.dsphitches.com

**This is a FULL TUBE FRAME installation!**

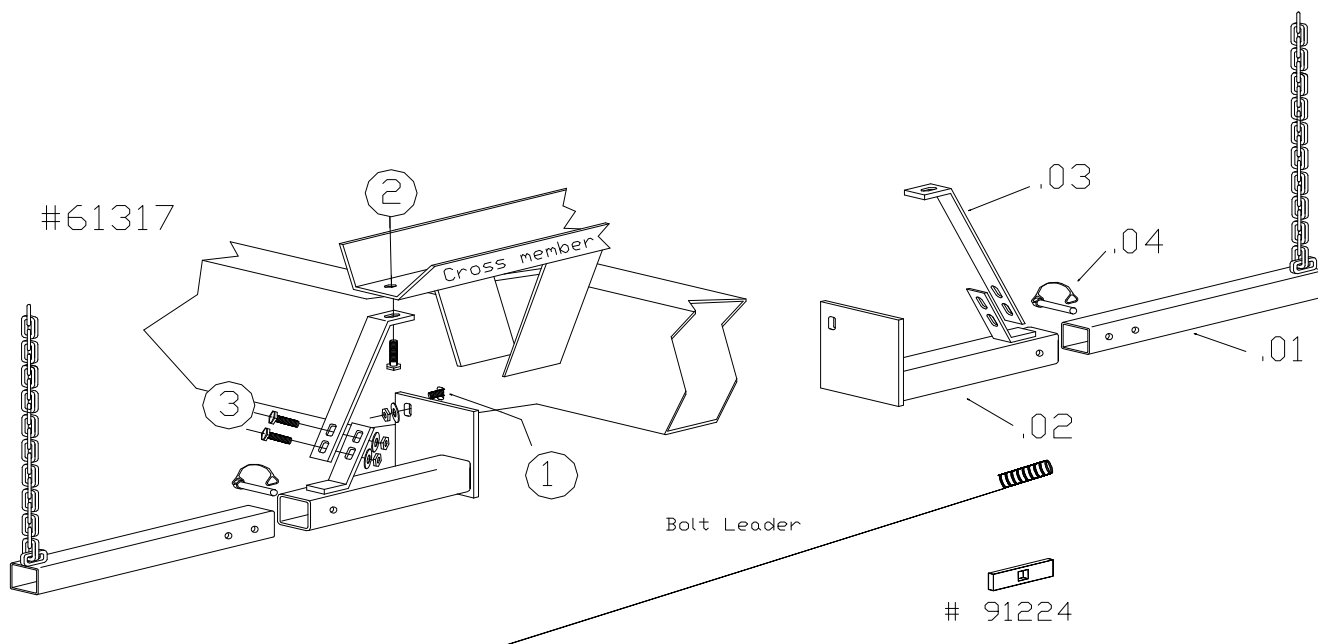

| Parts List |                            | Contents of Bolt Pack # 61317/B |   | Tools Required                                     |
|------------|----------------------------|---------------------------------|---|--|
| 1          | Mainbody Part# 61317/MBP   | 2                               | Spacer 1/2" Sq Hole 2-3/4"Lx3/4"Wx1/4"Mat     | 11/16" Socket or Wrench<br>100 FT/LB Torque Wrench |
| 1          | Mainbody Part # 61317/MBD  | 1                               | Bolt Leader 24"                               |  |
| 2          | Support Brackets           | 2                               | Carriage Bolt 1/2 x 2, Grade 5, UNC, Plated   |  |
| 2          | Tube Chain 17" # 63102     | 4                               | Hex Bolt 1/2-13 x 1-1/2, Grade 5, UNC, Plated |  |
| 1          | Bolt Pack 61317/B          | 6                               | Lock Washer 1/2", UNC, Grade 5, Plated        |  |
| 1          | Instructions T61000 Series | 6                               | Flat Washer 1/2, Plated                       |  |
|            |                            | 6                               | Hex Nut 1/2", UNC, Grade 5, Plated            |  |
| Shipping   | 32.6 lbs                   | 2                               | Quick Pin                                     | No Drill Application                               |
| Weight     | 14.8 kg                    |                                 |   |  |

**WARNING: Before grinding on the driver's side, locate fuel and electrical lines!**

1. Locate Tiedown hole #1 (see pictured above) on the frame and enlarge hole with die grinder to be able to fishwire in 1/2 x 2 carriage bolt and space #91224 using the supplied bolt leader. Place the main body over the carriage bolt and hold in place with flat washer, lock washer and hex nut. Handtighten.
2. Remove the box mount bolt from hole #2, install the crossmember support bracket using the same box mount bolt.
3. Attach the crossmember support bracket to the tiedown mainbody using 1/2 x 1-1/2" hex bolts, flat washer, lockwasher and hex nut. Handtighten.
4. Tighten all fasteners to torque specifications below.
5. Attach tube chain to main body using the supplied quick pin.
6. Repeat on other side.

| Bolt Size | Grade 5 Torque | Metric   | Grade 8.8 Torque |
|-----------|----------------|--|------------------|
| 3/8       | 30 Ft. Lb      | 8 mm   | 18 Ft. Lb.       |
| 7/16      | 54 Ft. Lb      | 10 mm  | 36 Ft. Lb.       |
| 1/2       | 72 Ft. Lb.     | 12 mm  | 75 Ft. Lb.       |
| 5/8       | 150 Ft. Lb     | 14 mm  | 103 Ft. Lb.      |
| 3/4       | 245 Ft. Lb     | Maximum torque for weld or weld nuts is 38 FT/Lb |                  |

**Warning: Check Fasteners annually or before usage, if the Tiedown is damaged replacement may be necessary.**

DO NOT drill or alter this product. This product is only intended for the application listed above, see vehicle owner's manual for maximum camper capacity (GVWR). This product is intended for usage with the correct towing accessories and not to be used with tow ropes, cables, chains or any type of stretch or elastic rope.

DSP Hitches are manufactured by 2114391 Alberta Ltd., Edmonton, Alberta, Canada  
For more information on DSP and DSP products call 1-800-265-3377 or visit us at www.dsphitches.com